



एन सी ई आर टी
NCERT

NCERT

National Council Of Educational Research
And Training

NCERT Solutions for 5th Class Maths Chapter 8-Mapping Your Way



IndCareer
Schools



indCareer



indCareer



indCareer

NCERT Solutions for 5th Class Maths Chapter 8-Mapping Your Way

Class 5: Maths Chapter 8 solutions. Complete Class 5 Maths Chapter 8 Notes.

NCERT Solutions for 5th Class Maths Chapter 8-Mapping Your Way

NCERT 5th Maths Chapter 8, class 5 Maths Chapter 8 solutions

Page 113

<https://www.indcareer.com/schools/ncert-solutions-for-5th-class-maths-chapter-8-mapping-your-way/>

Ans. 1. Yes, I have seen a map of a city. After matching the map with the photo, the position of India Gate is shown below.

2. The roads shown in the map are clearly visible in the photo. ‘

3. On my way from Rashtrapati Bhavan to India Gate I have crosses following roads: Rafi Marg, Janpath and Man Singh Road.

4. The National Stadium is seen in Map 1, but cannot be seen in the photo.

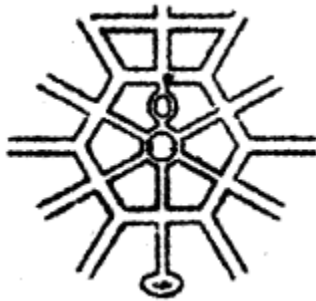

Page 114

The Central Hexagon

If we ‘zoom in’ to look more closely at one part of the map, it looks like this.

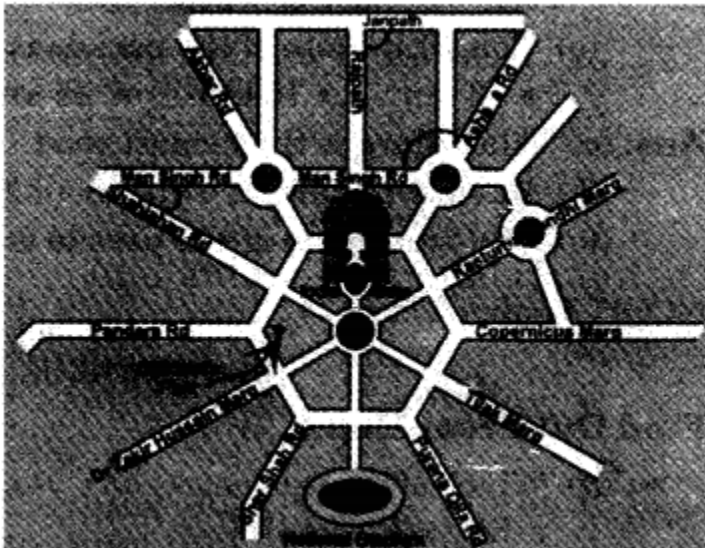

<https://www.indcareer.com/schools/ncert-solutions-for-5th-class-maths-chapter-8-mapping-your-way/>

1. Look at the shape of the yellow area. Have you seen this shape before? How many sides does it have?

Ans. Yes, I have seen this shape before. It has six sides.

This place is called the Central Hexagon.

NCERT 5th Maths Chapter 8, class 5 Maths Chapter 8 solutions

Find Out From the Map

1. If you are walking on Rajpath then after India Gate on which side would the Children's Park be?

2. Which of these roads make the biggest angle between them?

(a) Man Singh Road and Shahjahan Road.

(b) Ashoka Road and Man Singh Road (the angle away from India Gate)

(c) Janpath and Rajpath

3. Which of the above pairs of roads cut at right angles?

Ans. 1. Walking on Rajpath then after India Gate the Children's Park is on the right side.

2. (b) Ashoka Road and Man Singh Road.

3. Janpath and Rajpath cut at right angles.

Page 115

Waiting for the Parade

While waiting for the parade, Kancha and some of his friends wonder where this ; parade ends. Kancha is carrying a newspaper in which the route of the parade is written:

Vijay Chowk → Rajpath → India Gate → Tilak Marg → B. S. Zafar Marg → Subhash Marg → Red Fort

<https://www.indcareer.com/schools/ncert-solutions-for-5th-class-maths-chapter-8-mapping-your-way/>

Page 116

Mark the Route

1. Trace the route of the parade in Map 3 and mark India Gate and Rajpath.

Ans. The route map of the parade is given below.

2. Look at the map carefully and find out:

(a) Which of these is the longest road?

• B. S. Zafar Marg • Subhash Marg • Tilak Marg

(b) If Rubia is coming from Jama Masjid to join the parade, guess about how far she will have to walk.

(c) The total route of the parade is about how long?

• 3 km • 16 km • 25 km • 8 km

Ans. (a) Tilak Marg is the longest road.

(b) Rubia will have to walk about 1 km to join the parade.

(c) The total route of the parade is about 16 km long.

NCERT 5th Maths Chapter 8, class 5 Maths Chapter 8 solutions

Page 118

Find Out From Map 4

1. (a) Which of these is nearer to river Yamuna? – the Diwan-e-Aam or the Diwan-e-Khaas?

(b) Between which two buildings is Aar am Gah?

(c) Which buildings do you pass while going from Rang Mahal to the Hammam?

(d) Which building on this map is farthest from Meena Bazar?

<https://www.indcareer.com/schools/ncert-solutions-for-5th-class-maths-chapter-8-mapping-your-way/>

(e) About how far is Lahori Gate from Diwan-e-Khaas?

Ans. (a) The Diwan-e-Khaas is nearer to river Yamuna than Diwan-e-Aam.

(b) The Aram Gah lies between the Diwan-e-Khaas and Rang Mahal.

(c) While going from Rang Mahal to Hammam we pass Aram Gah, the Diwan-e-Khaas and Moti Masjid.

(d) Hammam is farthest from Meena Bazar.

(e) Lahori Gate is about 600 m from Diwan-e-Khas.

Page 119

Make it Bigger, Make it Smaller

1. Here are some pictures drawn on a 1 cm square grid. Try making the same pictures on a 2 cm grid and also on a $\frac{1}{2}$ cm grid. One picture is already done. The side of the square was made two times bigger. Does its area also become two times bigger?

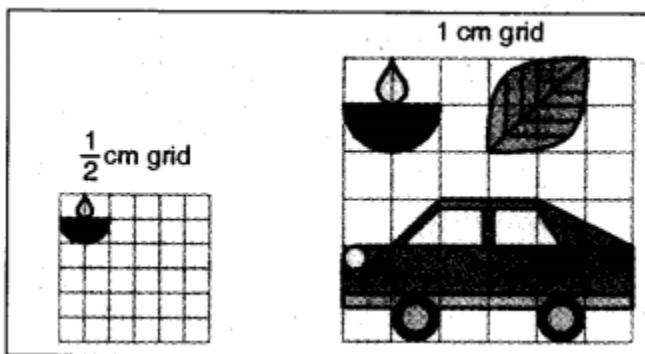

Ans.

<https://www.indcareer.com/schools/ncert-solutions-for-5th-class-maths-chapter-8-mapping-your-way/>

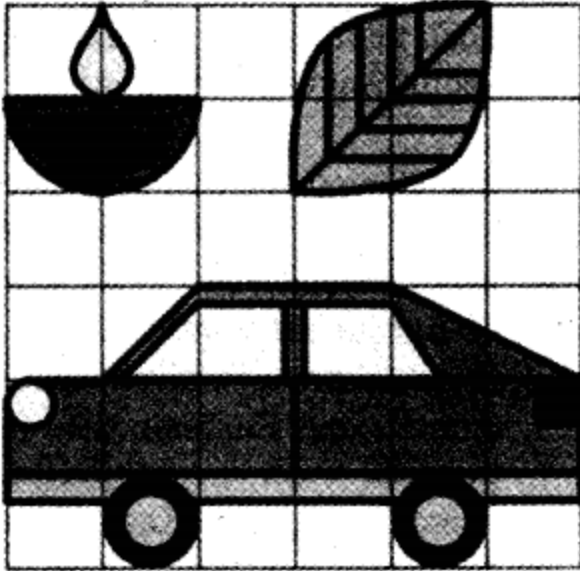

The area of square

= side x side = side².

When sides are doubled the area of square = 2 x Side x 2 x Side = 4 x side².

It is clear that the area becomes 4 times.

NCERT 5th Maths Chapter 8, class 5 Maths Chapter 8 solutions

Page 120

Now Try This

This is a part of the parade-route Map 3.

- 1. Can you see which part of the route-map it is?**
- 2. Now try to make it bigger in this 2 cm grid. Remember that the 'shape' of the map should not change.**
- 3. If the parade-route map is smaller, and the distance between India Gate and Vijay Chowk becomes 2 cm, what would be its scale?**

- 1 cm on map = 1 km on ground

<https://www.indcareer.com/schools/ncert-solutions-for-5th-class-maths-chapter-8-mapping-your-way/>

- $1/2$ cm on map = 1 km on ground
- 2 cm on map = 1 km on ground

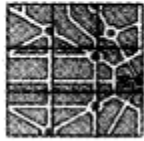

1 cm grid

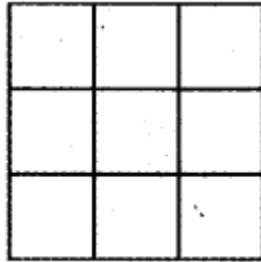

2 cm grid

Ans. 1. This part of the map indicates following:

Rajpath, Rail Marg, Janpath, Mansingh Road, India Gate, etc.

2. Its bigger size in 2 cm grid is drawn as following figure.

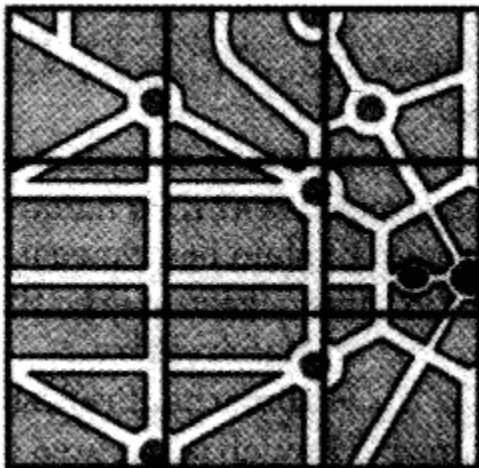

3. Its Scale would be 2 cm on map = 1 km on ground

Page 121

<https://www.indcareer.com/schools/ncert-solutions-for-5th-class-maths-chapter-8-mapping-your-way/>

1. Look at the map of India below and find the states these children are talking about. Answer the questions:

The Karnataka team starts from Bangalore and moves in the north direction. Which state does it cross to reach Delhi?

Ans. From Bangalore to Delhi, the team crosses following states:

Maharashtra, Madhya Pradesh and Uttar Pradesh

From Madhya Pradesh the team may also go through Haryana or Rajasthan.

2. Jammu and Kashmir is to the north of Delhi so the team from there, travels towards south to reach Delhi. Which states does it cross?

Ans. From Jammu and Kashmir to Delhi the team crosses following states: Himachal Pradesh, Punjab and Haryana.

3. Nonu lives in Gujarat. Nonu's friend Javed lives in West Bengal. Nonu wants to visit his friend. In which direction will he travel?

(a) Towards west (b) Towards east

(c) Towards south (d) Towards north

Ans. (b) Towards east

4. Is there any state which is to the north of Jammu and Kashmir?

Ans. No

5. Is there any state which is to the west of Gujarat?

Ans. No

6. If 1 cm on the map shows 200 km on the ground, use this scale to find out:

(A) About how far is Delhi from Jaipur?

(a) 50 km (b) 500 km (c) 250 km

(B) Estimate, how far is Jaipur from Bhopal?

<https://www.indcareer.com/schools/ncert-solutions-for-5th-class-maths-chapter-8-mapping-your-way/>

On the map = _____ cm

On the ground = _____ km

Ans. (A) (c) 250 km

(B) On the map = 2 cm

On the ground = 400 km

7. Look at the map and tell:

(a) Which state is surrounded by four other states?

(b) Which state has the largest area? If its name is not in the map, find it from your teacher or parents. Explain how you got your answer.

(c) Which state is about 8 times bigger in area than Sikkim?

• Uttar Pradesh • Maharashtra

• Tripura • Himachal Pradesh

(d) About how many times of Punjab is the area of Rajasthan?

Ans. (a) Madhya Pradesh

(b) Rajasthan; this can be easily observed by looking at the map. This can be confirmed by searching on the internet.

(c) Himachal Pradesh

(d) Rajasthan is about 7 times the area of Punjab

NCERT 5th Maths Chapter 8, class 5 Maths Chapter 8 solutions

Page 123

The Sea

1. Bala is standing on the sea-coast and looking at the vast sea. The sea looks endless.

<https://www.indcareer.com/schools/ncert-solutions-for-5th-class-maths-chapter-8-mapping-your-way/>

Have you seen the sea? In the picture where is the sea? Now look for the sea in the map of India. What colour is used to show the sea.

Mark those states which have the sea on one side.

Name one state which does not have the sea on any side.

Ans. Yes, I have seen the sea. In the picture the sea is opposite to Bala. Blue colour is used to show sea on the map.



States which have sea on their one side are: Gujarat, Maharashtra, Karnataka, Kerala, Tamil Nadu and West Bengal.

Bihar is one example of states which do not have sea on any one side.

Page 124

Distances between Towns

<https://www.indcareer.com/schools/ncert-solutions-for-5th-class-maths-chapter-8-mapping-your-way/>

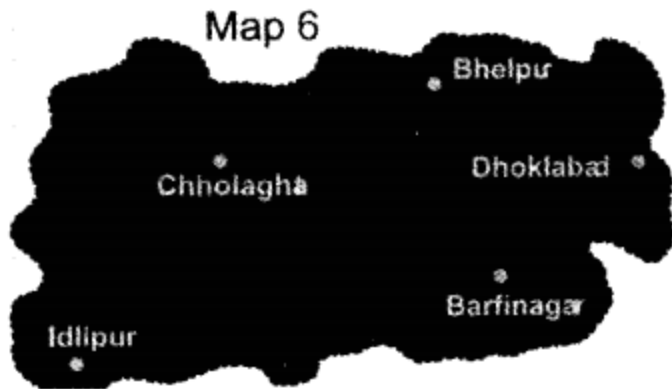

There are five towns. Find out:

1. How many cm away is Idlipur from Barfinagar on the map?

Ans. Idlipur is 4.7 cm away from Barfinagar, on the map.

2. Measure the length of the route between Bhelpur and Chholaghat. (You can use a thread).

Ans. On the map the distance between Bhelpur and Chholaghat = 5.5 cm Hence,
Distance = $10 \times 5.5 \text{ km} = 55 \text{ km}$

Page 124

Ashi's School

Ashi's school looks like this from the top.

<https://www.indcareer.com/schools/ncert-solutions-for-5th-class-maths-chapter-8-mapping-your-way/>

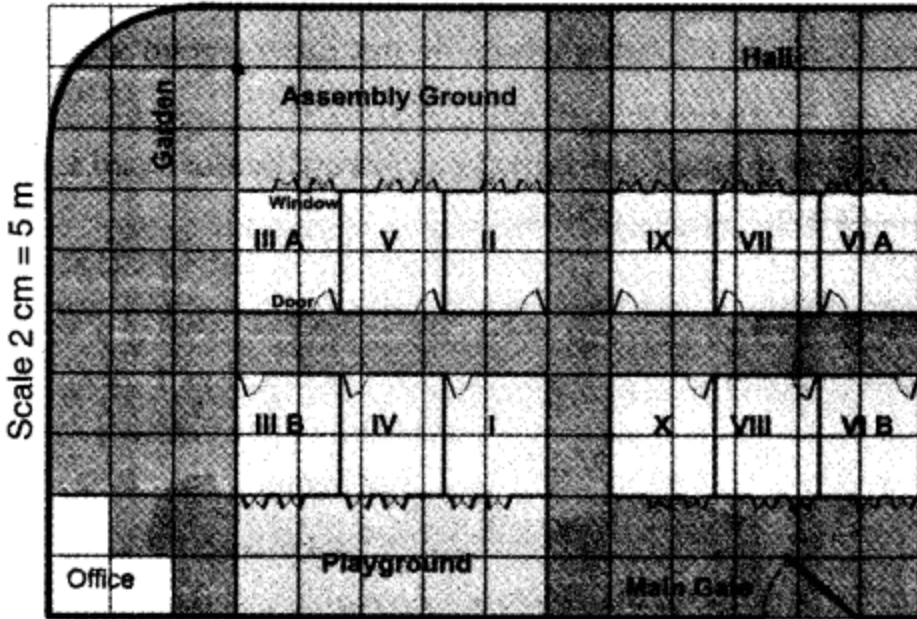

Use the squares to find out:

1. How many times bigger is the area of the Assembly ground than that of the office?

Ans. The area of the Assembly ground is 5 times that of the office.

2. How much is the length and width of each classroom?

(a) Length 5 m, width 4 m (b) Length 2 m, width 1 m

(c) Length 12 m, width 10 m (d) Length 5 m, width 5 m

Ans. (a) Length 5 m, width 4 m

3. All classrooms in Ashi's school look like this.

<https://www.indcareer.com/schools/ncert-solutions-for-5th-class-maths-chapter-8-mapping-your-way/>

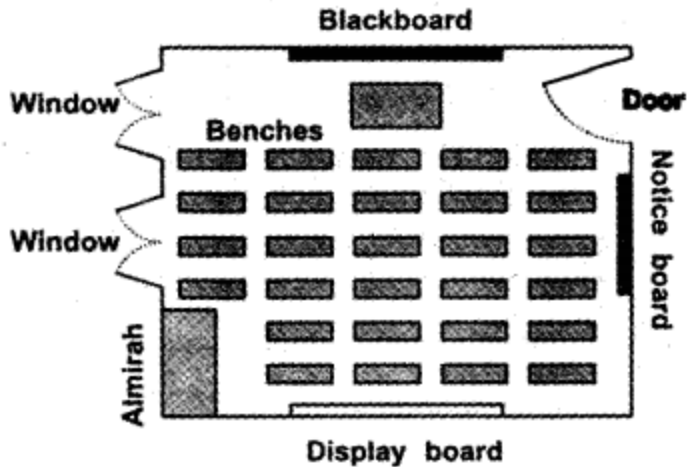

Look carefully and answer.

(a) Which of these is exactly opposite to the blackboard?

Almirah, windows, notice board, display board

Ans. Display board is exactly opposite to the blackboard

(b) Now look at the school map again. Guess and mark where would these be:

- Blackboard in III A and VII
- Almirah in IV and X
- Notice board in V and VI B
- Last seat of middle row in II
- Display board in I

Ans. The things on the map are shown in following figure:

<https://www.indcareer.com/schools/ncert-solutions-for-5th-class-maths-chapter-8-mapping-your-way/>

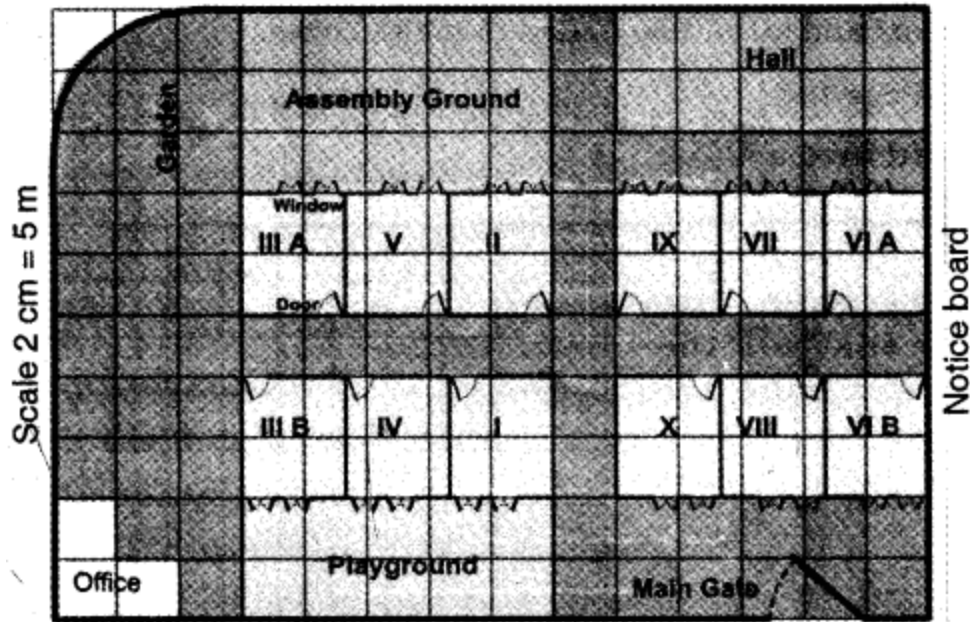

(c) Can a child sitting in III A see the playground?

Ans. No, a child sitting in III A cannot see the playground.

NCERT 5th Maths Chapter 8, class 5 Maths Chapter 8 solutions



<https://www.indcareer.com/schools/ncert-solutions-for-5th-class-maths-chapter-8-mapping-your-way/>

Chapterwise NCERT Solutions for Class 5 Maths :

- Chapter 1: The fish Tale
- Chapter 2: Shapes and Angles
- Chapter 3: How Many Squares?
- Chapter 4: Parts and Wholes
- Chapter 5: Does it Look the Same?
- Chapter 6: Be My Multiple, I'll be Your Factor
- Chapter 7: Can You See the Pattern?
- Chapter 8: Mapping Your Way
- Chapter 9: Boxes and Sketches
- Chapter 10: Tenths and Hundredths
- Chapter 11: Area and its Boundary
- Chapter 12: Smart Charts
- Chapter 13: Ways to Multiply and Divide
- Chapter 14: How Big? How Heavy?

<https://www.indcareer.com/schools/ncert-solutions-for-5th-class-maths-chapter-8-mapping-your-way/>

About NCERT

The National Council of Educational Research and Training is an autonomous organization of the Government of India which was established in 1961 as a literary, scientific, and charitable Society under the Societies Registration Act. The major objectives of NCERT and its constituent units are to: undertake, promote and coordinate research in areas related to school education; prepare and publish model textbooks, supplementary material, newsletters, journals and develop educational kits, multimedia digital materials, etc. Organise pre-service and in-service training of teachers; develop and disseminate innovative educational techniques and practices; collaborate and network with state educational departments, universities, NGOs and other educational institutions; act as a clearing house for ideas and information in matters related to school education; and act as a nodal agency for achieving the goals of Universalisation of Elementary Education. In addition to research, development, training, extension, publication and dissemination activities, NCERT is an implementation agency for bilateral cultural exchange programmes with other countries in the field of school education. Its headquarters are located at Sri Aurobindo Marg in New Delhi. [Visit the Official NCERT website](#) to learn more.

<https://www.indcareer.com/schools/ncert-solutions-for-5th-class-maths-chapter-8-mapping-your-way/>